

Kabelstecker  
Male cable connector

Kabelstecker, rot, blau, grün  
Male cable connector, red, blue, green

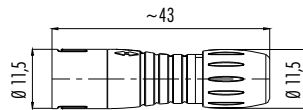

Polzahl Contacts	Kabeldurchlass max. Max. cable outlet	Bestell-Nr. Ordering-No.	Polzahl Contacts	Kabel-Ø max. Max. cable Ø	Rot Red	Blau Blue	Grün Green
3	3,5–5 mm	99 9205 00 03	3	3,5–5 mm	99 9205 050 03	99 9205 060 03	99 9205 070 03
4	3,5–5 mm	99 9209 00 04	4	3,5–5 mm	99 9209 050 04	99 9209 060 04	99 9209 070 04
5	3,5–5 mm	99 9213 00 05	5	3,5–5 mm	99 9213 050 05	99 9213 060 05	99 9213 070 05
8	3,5–5 mm	99 9225 00 08	8	3,5–5 mm	99 9225 050 08	99 9225 060 08	99 9225 070 08

Polzahl	3	4	5	8	Number of contacts
Steckverbinder Verriegelung	schnapp/snap-in				Connector locking system
Anschlussart	löten/solder				Termination
Anschlussquerschnitt	max. 0,25 mm <sup>2</sup> (max. AWG 24)				Wire gauge
Kabeldurchlass	3,5–5 mm				Cable outlet
Schutzart	IP67				Degree of protection
Mechanische Lebensdauer	> 500 Steckzyklen/> 500 mating cycles				Mechanical operation
Obere Grenztemperatur	+ 85 °C				Upper temperature
Untere Grenztemperatur	– 25 °C				Lower temperature
Bemessungsspannung	125 V			63 V	Rated voltage
Bemessungs-Stoßspannung	1500 V			800 V	Rated impulse voltage
Verschmutzungsgrad	2				Pollution degree
Überspannungskategorie	II				Overvoltage categorie
Isolierstoffgruppe	II				Material group
Bemessungsstrom (40°C)	3 A	2,5 A	2 A	1 A	Rated current (40 °C)
Material Kontakt	CuZn (Messing/brass)				Material of contact
Kontaktoberfläche	Au (Gold/gold)				Contact plating
Material Kontaktkörper	PA				Material of contact body
Material Gehäuse	PA				Material of housing
Material Verriegelung	—				Material of locking

Kabeldose  
Female cable connector

Kabeldose, rot, blau, grün  
Female cable connector, red, blue, green

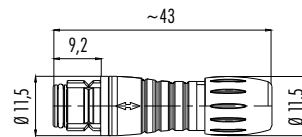

Polzahl Contacts	Kabeldurchlass max. Max. cable outlet	Bestell-Nr. Ordering-No.	Polzahl Contacts	Kabel-Ø max. Max. cable Ø	Rot Red	Blau Blue	Grün Green
3	3,5–5 mm	99 9206 00 03	3	3,5–5 mm	99 9206 050 03	99 9206 060 03	99 9206 070 03
4	3,5–5 mm	99 9210 00 04	4	3,5–5 mm	99 9210 050 04	99 9210 060 04	99 9210 070 04
5	3,5–5 mm	99 9214 00 05	5	3,5–5 mm	99 9214 050 05	99 9214 060 05	99 9214 070 05
8	3,5–5 mm	99 9226 00 08	8	3,5–5 mm	99 9226 050 08	99 9226 060 08	99 9226 070 08

Polzahl	3	4	5	8	Number of contacts
Steckverbinder Verriegelung	schnapp/snap-in				Connector locking system
Anschlussart	löten/solder				Termination
Anschlussquerschnitt	max. 0,25 mm <sup>2</sup> (max. AWG 24)				Wire gauge
Kabeldurchlass	3,5–5 mm				Cable outlet
Schutzart	IP67				Degree of protection
Mechanische Lebensdauer	> 500 Steckzyklen/> 500 mating cycles				Mechanical operation
Obere Grenztemperatur	+ 85 °C				Upper temperature
Untere Grenztemperatur	– 25 °C				Lower temperature
Bemessungsspannung	125 V			63 V	Rated voltage
Bemessungs-Stoßspannung	1500 V			800 V	Rated impulse voltage
Verschmutzungsgrad	2				Pollution degree
Überspannungskategorie	II				Overvoltage categorie
Isolierstoffgruppe	II				Material group
Bemessungsstrom (40°C)	3 A	2,5 A	2 A	1 A	Rated current (40 °C)
Material Kontakt	CuSn (Bronze/bronze)				Material of contact
Kontaktoberfläche	Au (Gold/gold)				Contact plating
Material Kontaktkörper	PA				Material of contact body
Material Gehäuse	PA				Material of housing
Material Verriegelung	—				Material of locking

Flanschstecker  
Male panel mount connector

Flanschstecker, rot  
Male panel mount connector, red

Flanschstecker, blau  
Male panel mount connector, blue

Flanschstecker, grün  
Male panel mount connector, green

Flanschstecker, tauchlöten  
Male panel mount connector,  
dip solder



Bohrbilder siehe Seite 16  
Drilling schemes see page 16

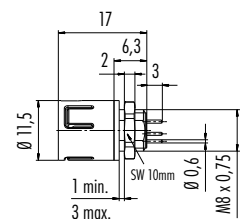
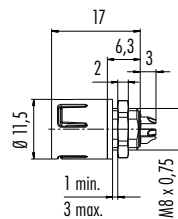

Polzahl Contacts	Bestell-Nr. Ordering-No.	Polzahl Contacts	Bestell-Nr. Ordering-No.	Polzahl Contacts	Bestell-Nr. Ordering-No.	Polzahl Contacts	Bestell-Nr. Ordering-No.	Polzahl Contacts	Bestell-Nr. Ordering-No.
3	99 9207 00 03	3	99 9207 050 03	3	99 9207 060 03	3	99 9207 070 03	3	99 9207 090 03
4	99 9211 00 04	4	99 9211 050 03	4	99 9211 060 04	4	99 9211 070 04	4	99 9211 090 04
5	99 9215 00 05	5	99 9215 050 05	5	99 9215 060 05	5	99 9215 070 05	5	99 9215 090 05
8	99 9227 00 08	8	99 9227 050 08	8	99 9227 060 08	8	99 9227 070 08	8	99 9227 090 08

Polzahl	3	4	5	8	Number of contacts
Steckverbinder Verriegelung	schnapp/snap-in				Connector locking system
Anschlussart	löten/tauchlöten/solder/dip solder				Termination
Anschlussquerschnitt	max. 0,25 mm <sup>2</sup> (max. AWG 24)/ —				Wire gauge
Kabeldurchlass	—				Cable outlet
Schutzart	IP67				Degree of protection
Mechanische Lebensdauer	> 500 Steckzyklen/> 500 mating cycles				Mechanical operation
Obere Grenztemperatur	+ 85 °C				Upper temperature
Untere Grenztemperatur	- 25 °C				Lower temperature
Bemessungsspannung	125 V			63 V	Rated voltage
Bemessungs-Stoßspannung	1500 V			800 V	Rated impulse voltage
Verschmutzungsgrad	2				Pollution degree
Überspannungskategorie	II				Overvoltage categorie
Isolierstoffgruppe	II				Material group
Bemessungsstrom (40°C)	3 A	2,5 A	2 A	1 A	Rated current (40 °C)
Material Kontakt	CuZn (Messing/brass)				Material of contact
Kontaktoberfläche	Au (Gold/gold)				Contact plating
Material Kontaktkörper	PA				Material of contact body
Material Gehäuse	PA				Material of housing
Material Verriegelung	—				Material of locking

Flanschdose  
Female panel mount connector



Flanschdose, rot  
Female panel mount connector, red



Flanschdose, blau  
Female panel mount connector, blue



Flanschdose, grün  
Female panel mount connector, green



Flanschdose, tauchlöten  
Female panel mount connector,  
dip solder



Bohrbilder siehe Seite 16  
Drilling schemes see page 16

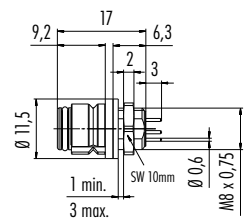
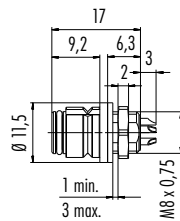

Polzahl Contacts	Bestell-Nr. Ordering-No.	Polzahl Contacts	Bestell-Nr. Ordering-No.	Polzahl Contacts	Bestell-Nr. Ordering-No.	Polzahl Contacts	Bestell-Nr. Ordering-No.	Polzahl Contacts	Bestell-Nr. Ordering-No.
3	99 9208 00 03	3	99 9208 050 03	3	99 9208 060 03	3	99 9208 070 03	3	99 9208 090 03
4	99 9212 00 04	4	99 9212 050 04	4	99 9212 060 04	4	99 9212 070 04	4	99 9212 090 04
5	99 9216 00 05	5	99 9216 050 05	5	99 9216 060 05	5	99 9216 070 05	5	99 9216 090 05
8	99 9228 00 08	8	99 9228 050 08	8	99 9228 060 08	8	99 9228 070 08	8	99 9228 090 08

Polzahl	3	4	5	8	Number of contacts
Steckverbinder Verriegelung	schnapp/snap-in				Connector locking system
Anschlussart	löten/tauchlöten/solder/dip solder				Termination
Anschlussquerschnitt	max. 0,25 mm <sup>2</sup> (max. AWG 24)/ —				Wire gauge
Kabeldurchlass	—				Cable outlet
Schutzart	IP67				Degree of protection
Mechanische Lebensdauer	> 500 Steckzyklen/> 500 mating cycles				Mechanical operation
Obere Grenztemperatur	+ 85 °C				Upper temperature
Untere Grenztemperatur	- 25 °C				Lower temperature
Bemessungsspannung	125 V			63 V	Rated voltage
Bemessungs-Stoßspannung	1500 V			800 V	Rated impulse voltage
Verschmutzungsgrad	2				Pollution degree
Überspannungskategorie	II				Overvoltage categorie
Isolierstoffgruppe	II				Material group
Bemessungsstrom (40°C)	3 A	2,5 A	2 A	1 A	Rated current (40 °C)
Material Kontakt	CuSn (Bronze/bronze)				Material of contact
Kontaktoberfläche	Au (Gold/gold)				Contact plating
Material Kontaktkörper	PA				Material of contact body
Material Gehäuse	PA				Material of housing
Material Verriegelung	—				Material of locking

Kabelstecker umspritzt  
Male cable connector moulded

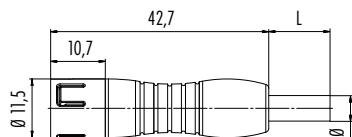

Kabeldose umspritzt  
Female cable connector moulded

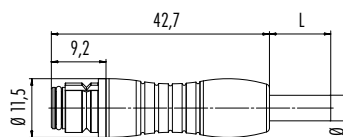

Polzahl Contacts	Kabellänge Cable length	Bestell-Nr. Ordering-No.
3	2 m	77 7405 0000 50003 - 0200
4	2 m	77 7405 0000 50004 - 0200
5	2 m	77 7405 0000 50005 - 0200
8	2 m	77 7405 0000 50008 - 0200

Polzahl Contacts	Kabellänge Cable length	Bestell-Nr. Ordering-No.
3	2 m	77 7406 0000 50003 - 0200
4	2 m	77 7406 0000 50004 - 0200
5	2 m	77 7406 0000 50005 - 0200
8	2 m	77 7406 0000 50008 - 0200

Technische Daten Kabel	3	4	5	8	Specifications of cable
Querschnitt mm <sup>2</sup> <sup>1)</sup>	3 x 0,25 mm <sup>2</sup> (AWG 24)	4 x 0,25 mm <sup>2</sup> (AWG 24)	5 x 0,25 mm <sup>2</sup> (AWG 24)	8 x 0,25 mm <sup>2</sup> (AWG 24)	Wire gauge mm <sup>2</sup> <sup>1)</sup>
Material Mantel	PUR				Material jacket
Isolation Litze	PP		PVC	PP	Insulation wire
Litzenaufbau (mm)	32 x 0,1				Design of wire (mm)
Kabelmantel Ø (mm)	3,6 ±0,1	4,5 ±0,1	4,95 ±0,15	6 ±0,2	Cable jacket Ø (mm)
Leiterwiderstand	80 Ω/Km (20 °C)		78 Ω/Km (20 °C)	79 Ω/Km (20 °C)	Resistance of wire
Temp.-Bereich (Kabel bew.)	- 25 °C /+ 80 °C	- 25 °C /+ 90 °C	- 15 °C /+ 80 °C	- 25 °C /+ 80 °C	Temp. range (cable in move)
Temp.-Bereich (Kabel fest)	- 40 °C /+ 80 °C	- 40 °C /+ 90 °C	- 30 °C /+ 80 °C	- 50 °C /+ 80 °C	Temp. range (cable fixed)
Biegeradius (Kabel bew.)	36 mm	45 mm	49,5 mm	60 mm	Bending radius (cable in move)
Biegeradius (Kabel fest)	18 mm	22,5 mm	24,75 mm	30 mm	Bending radius (cable fixed)
Zulassung	UL				Approval

Polzahl	3	4	5	8	Number of contacts
Steckverbinder Verriegelung	schnapp/snap-in				Connector locking system
Anschlussart	am Kabel angespritzt/moulded				Termination
Anschlussquerschnitt	max. 0,25 mm <sup>2</sup> (max. AWG 24)				Wire gauge
Kabeldurchlass	—				Cable outlet
Schutzart	IP67				Degree of protection
Mechanische Lebensdauer	> 500 Steckzyklen/> 500 mating cycles				Mechanical operation
Obere Grenztemperatur	+ 70 °C				Upper temperature
Untere Grenztemperatur	- 25 °C				Lower temperature
Bemessungsspannung	125 V		63 V		Rated voltage
Bemessungs-Stoßspannung	1500 V		800 V		Rated impulse voltage
Verschmutzungsgrad	2				Pollution degree
Überspannungskategorie	II				Overvoltage categorie
Isolierstoffgruppe	II				Material group
Bemessungsstrom (40°C)	3 A	2,5 A	2 A	1 A	Rated current (40 °C)
Material Kontakt	Stift/pin CuZn (Messing/brass), Buchse/socket CuSn (Bronze/bronze)				Material of contact
Kontaktoberfläche	Au (Gold/gold)				Contact plating
Material Kontaktkörper	PA				Material of contact body
Material Gehäuse	PUR				Material of housing
Material Verriegelung	—				Material of locking

Montageanleitung  
Assembly instruction

1. Abmanteln auf L = 12 mm.
2. Druckschraube, Klemmkorb, Dichtring und Kupplungshülse auf Kabel auffädeln.
3. O-Ring auf Kontakteinsatz aufziehen.
4. Litzen abisolieren und anlöten.
5. Kupplungshülse aufschrauben.
6. Druckschraube festdrehen.

1. Dismantle cable to 12 mm length.
2. Bead pressing screw, pinch ring, seal and sleeve to cable.
3. Fit O-ring on the contact insert.
4. Strip and solder single wires.
5. Screw on sleeve.
6. Tighten pressing screw.

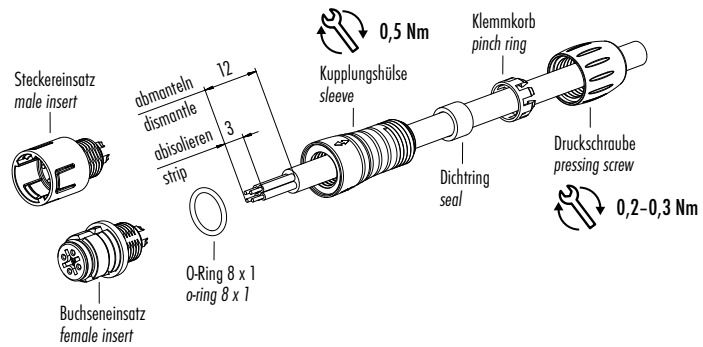

Einzelteildarstellung  
Component part drawing

Flanschsteckverbinder, löten  
Panel mount connectors, solder

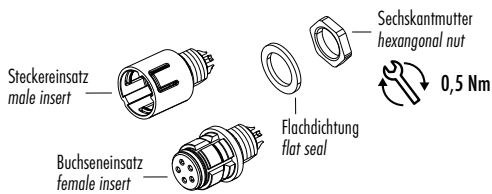

Flanschsteckverbinder, tauchlöten  
Panel mount connectors, dip solder

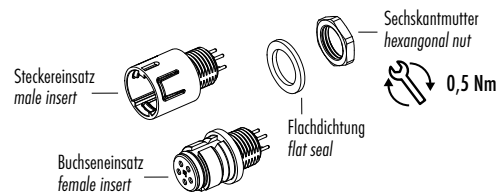

Montage Adapter  
Assembly of adapter

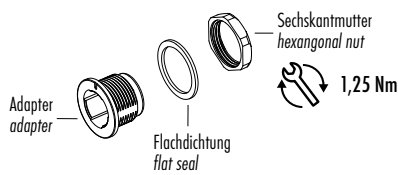

Montage Adapter, von vorn verschraubbar  
Assembly of adapter, front fastened

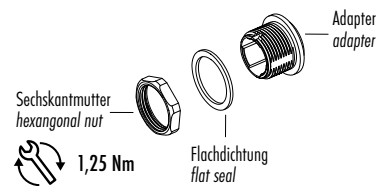

Adapter  
Adapter

Die Markierung des Adapters muss mit der Kodiernase des Einsatzes übereinstimmen  
The marking of the adapter must conform with the coding nut of the insert

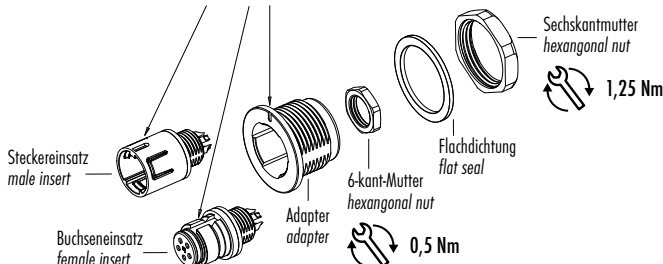

Einsätze müssen separat bestellt werden  
Inserts have to be ordered separately

Adapter, von vorn verschraubbar  
Adapter, front fastened

Die Markierung des Adapters muss mit der Kodiernase des Einsatzes übereinstimmen  
The marking of the adapter must conform with the coding nut of the insert

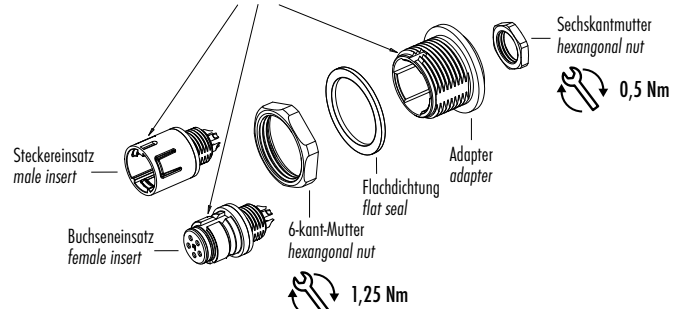

Einsätze müssen separat bestellt werden  
Inserts have to be ordered separately

Polbilder  
Contact arrangements

Stifteinsatz (Steckseite)  
Male insert (mating side)

Buchseinsatz (Steckseite)  
Female insert (mating side)

3 pol  
3 contacts

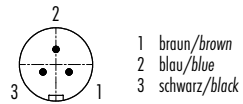

- 1 braun/brown
- 2 blau/blue
- 3 schwarz/black

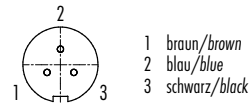

- 1 braun/brown
- 2 blau/blue
- 3 schwarz/black

4 pol  
4 contacts

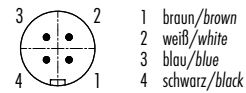

- 1 braun/brown
- 2 weiß/white
- 3 blau/blue
- 4 schwarz/black

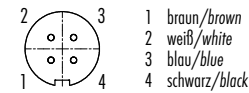

- 1 braun/brown
- 2 weiß/white
- 3 blau/blue
- 4 schwarz/black

5 pol  
5 contacts

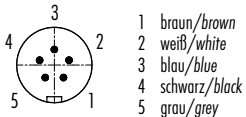

- 1 braun/brown
- 2 weiß/white
- 3 blau/blue
- 4 schwarz/black
- 5 grau/grey

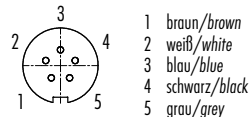

- 1 braun/brown
- 2 weiß/white
- 3 blau/blue
- 4 schwarz/black
- 5 grau/grey

8 pol  
8 contacts

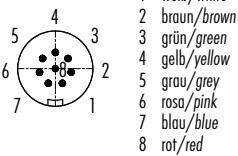

- 1 weiß/white
- 2 braun/brown
- 3 grün/green
- 4 gelb/yellow
- 5 grau/grey
- 6 rosa/pink
- 7 blau/blue
- 8 rot/red

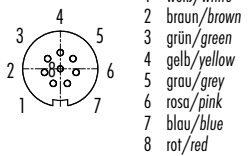

- 1 weiß/white
- 2 braun/brown
- 3 grün/green
- 4 gelb/yellow
- 5 grau/grey
- 6 rosa/pink
- 7 blau/blue
- 8 rot/red

Bohrbilder Stifteinsatz (Leiterplatte)  
Drilling schemes male insert (PCB)

Bohrbilder Buchseinsatz (Leiterplatte)  
Drilling schemes female insert (PCB)

3 pol  
3 contacts

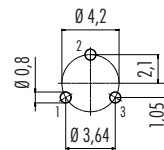
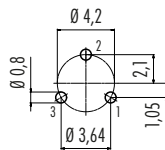

4 pol  
4 contacts

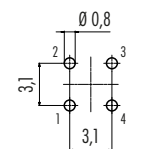
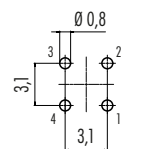

5 pol  
5 contacts

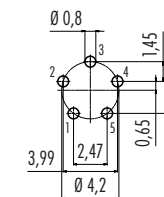
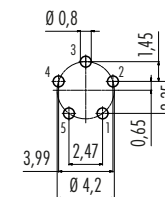

8 pol  
8 contacts

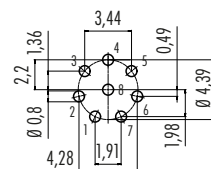
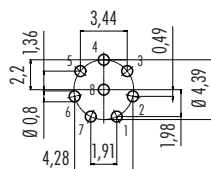

Montageausschnitt  
Panel cut out

Flanschsteckverbinder  
Socket connectors

Adapter  
Adapter

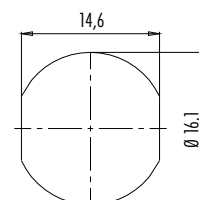
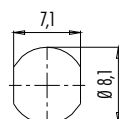

Bezeichnung / Description	Maßzeichnung / Drawing	Bestell-Nr. / Ordering-No.
Schutzkappe für Kabelstecker Protection cap for male cable connector		08 2813 000 000
Schutzkappe für Kabeldose Protection cap for female cable connector		08 2823 000 000
Schutzkappe für Flanschstecker Protection cap for male panel mount connector		08 2839 000 000
Schutzkappe für Flanschdose Protection cap for female panel mount connector		08 2831 000 000
Adapter für Flanschsteckverbinder Adapter for panel mount connectors		08 2636 000 001
Adapter für Flanschsteckverbinder, von vorn verschraubt Adapter for panel mount connectors, front fastened		08 2629 000 001
Sicherungsclip Safety clip		08 0219 000 000

Anwendungsbeispiel für Adapter  
Example for use for adapter

Flanschstecker  
Male panel mount connector



Flanschstecker mit Adapter  
Male panel mount connector with adapter



Flanschdose  
Female panel mount connector



Flanschdose mit Adapter, von vorn verschraubbar  
Female panel mount connector with adapter, front fastened

